

## 2.2 MODULAR CONNECTOR SYSTEMS

**arcoPlus®**  
Reversò 684|6104|6124  
8mm 10mm 12mm

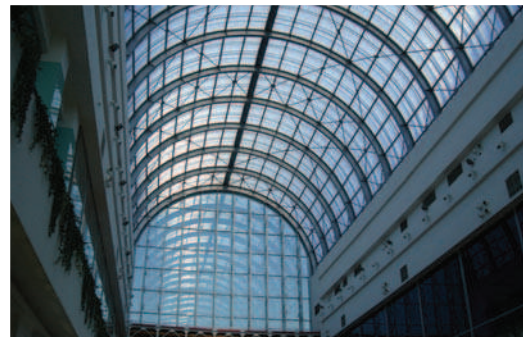

### PROFILE

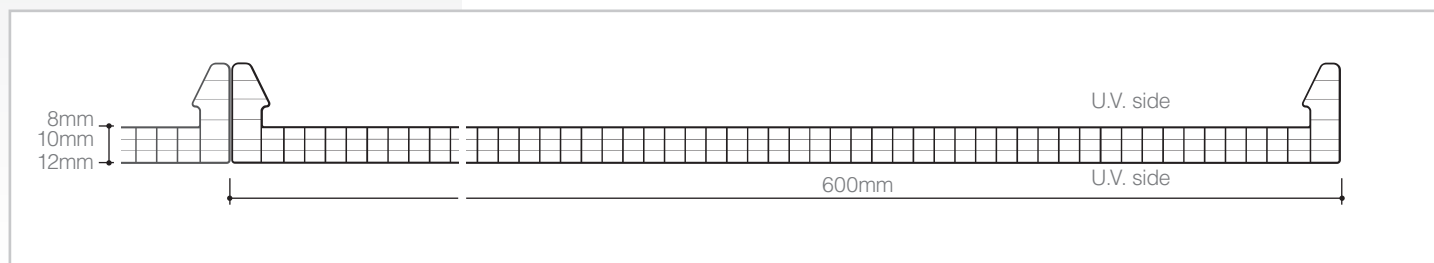

## Modular system of bi-protected multiwall polycarbonate for translucent roofing applications



LIGHT MANAGEMENT



PRODUCT AVAILABLE  
WITH IR AND AR TREATMENT

### PRODUCTION STANDARDS

Thickness	8-10-12mm
Structure	4 walls
Effective modular width	600mm
Panel length	no limit
Colours available	see page 11

### TECHNICAL FEATURES

Thermal insulation	3,3 - 3,0 - 2,7 W/m <sup>2</sup> K
Acoustic insulation	18 dB (th.8-10mm) 19dB (th.12mm)
Linear thermal expansion	0,065mm/m°C
Temperature range	-40°C +120 °C
U.V. rays protection	2 sides Coextrusion
Fire reaction EN 13501	EuroClass B-s1,d0

### DESCRIPTION

arcoPlus®684-6104-6124 reversò are three modular systems consisting of 4 walls polycarbonate panels with UV protection on two sides and thicknesses of 8-10-12mm. They are anchored to the existing structures using specific anchor brackets. The panels are joined together using a protected polycarbonate or aluminium cover plate profile assembled using a click-on system to guarantee a perfectly watertight seal.

### ADVANTAGES

- ❖ Easy and low-cost installation
- ❖ Light transmission
- ❖ Resistance to U.V. rays and to hail
- ❖ Heat insulation
- ❖ Bendability R.min=2,5m

### APPLICATIONS

 Roofing

 Curved roofing

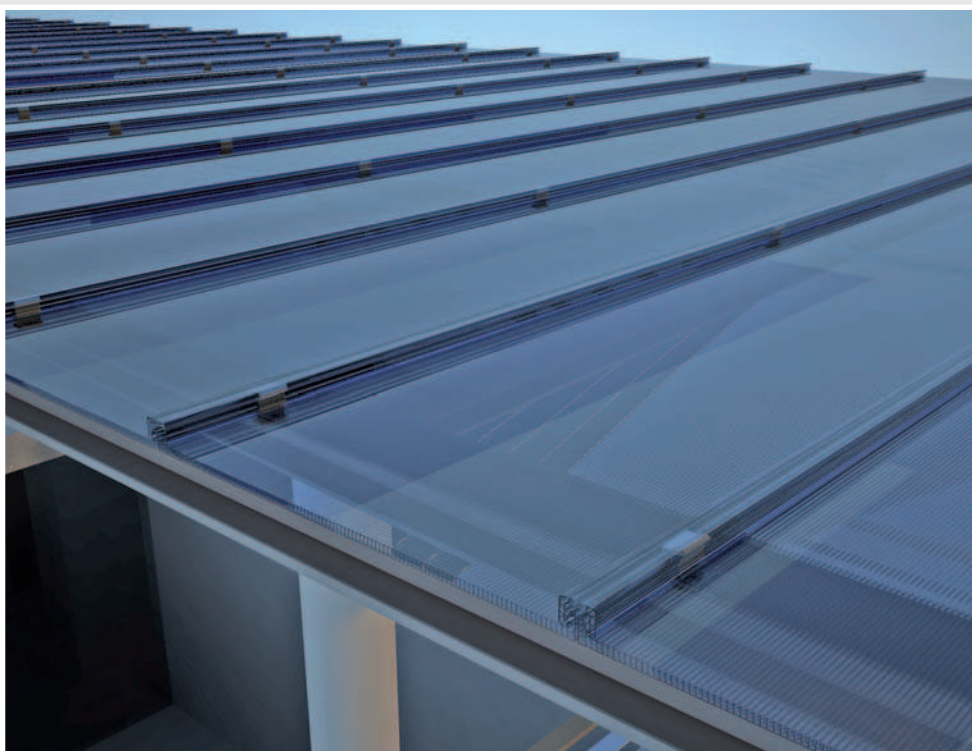

### CONTINUOUS ROOFING

Example of roofing with polycarbonate cover plate



## LOAD RESISTANCE

### Maximum loads on two supports

Values below refer to product installed according to the Technical Handbook Recommendation

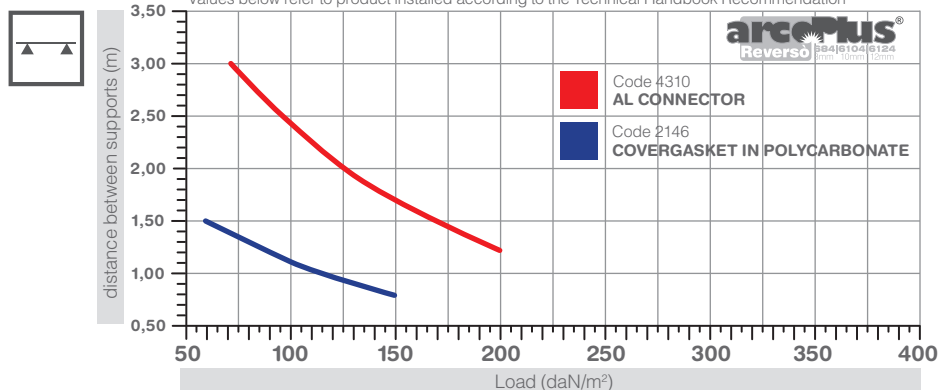

### Maximum loads on more supports

Values below refer to product installed according to the Technical Handbook Recommendation

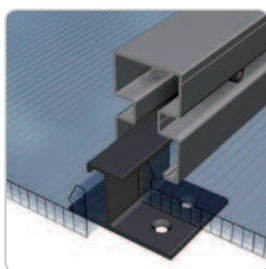
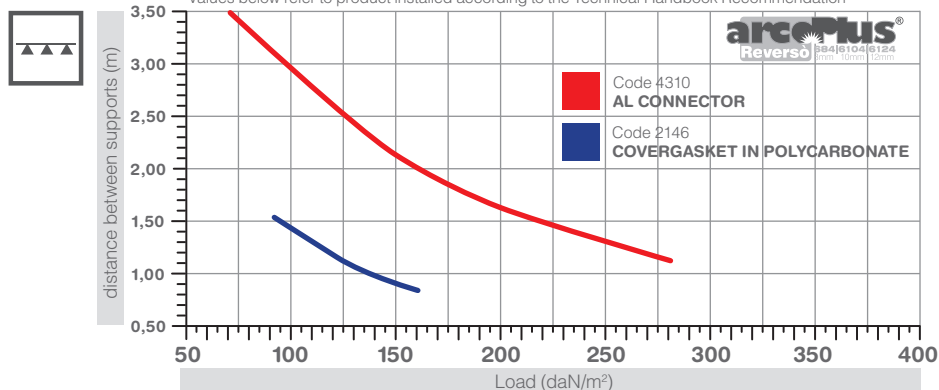

**SYSTEM WITH ALUMINIUM CONNECTOR CODE 4310**

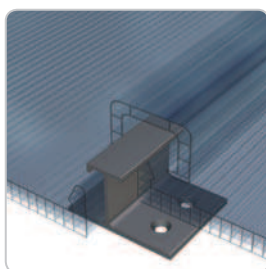

**SYSTEM WITH POLYCARBONATE COVERGASKET - CODE 2146**

## EASY AND LOW-COST INSTALLATION

To ensure compliance with snow load and negative wind load resistance requirements, anchor brackets should be fitted for each purlin.

The polycarbonate panels are fastened to the underlying structure using specific brackets, which must be anchored to the purlins using suitable

self-drilling/self-tapping screws (on metal structures) and tap bolts (for wooden structures). These screws and bolts are not supplied.

Different connector profiles can be used, depending on the required load specifications.





## COMPLETE SYSTEM FOR ROOFING

The modular polycarbonate panels can be used to create flat or curved roofing. They are fixed to the supporting structures using specific aluminium brackets. Depending on the load capacity values

required, or the distance between the purlins of the underlying structures, either polycarbonate cover plates, aluminium connectors.

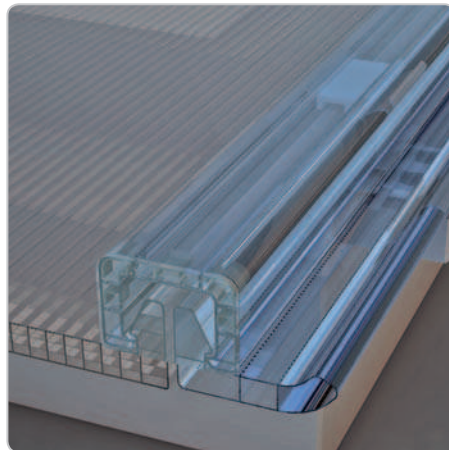

**START PROFILE**  
Detail of insertion of start profile on roof

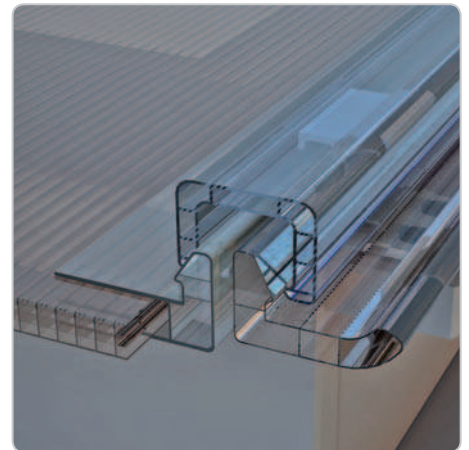

**END PROFILE**  
Detail of insertion of section-breaker profile to complete roofing

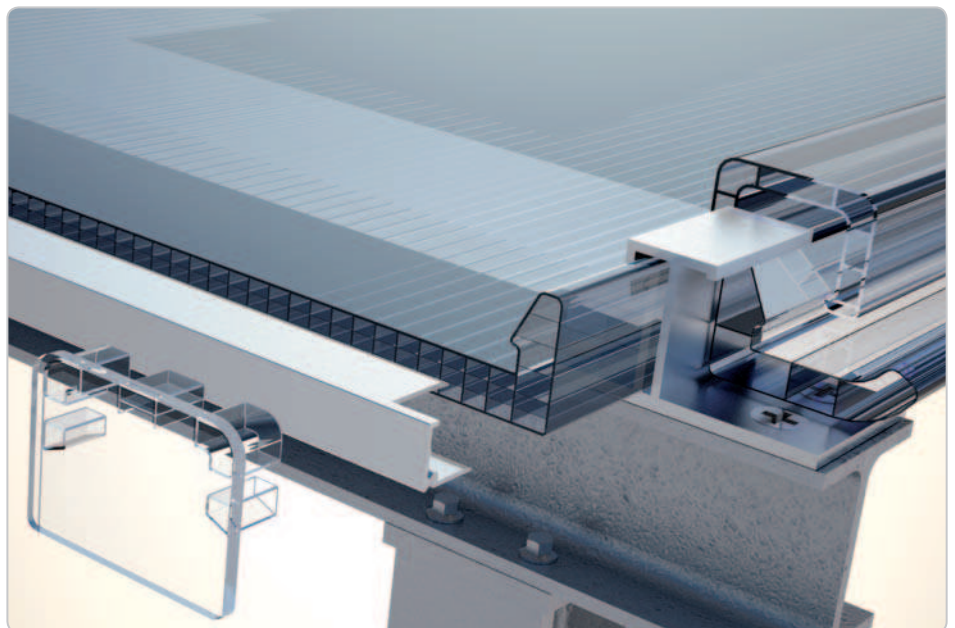

**DETAIL OF COMPLETE SYSTEM**  
Start profile with panel, cover plate, plate and air cell cover profiles

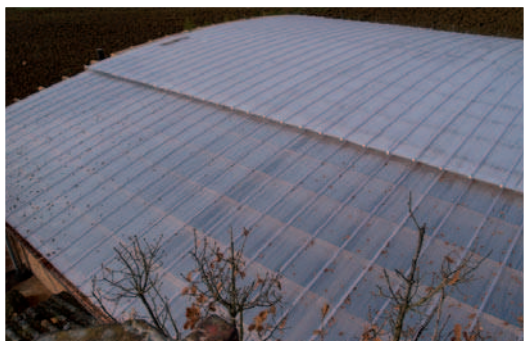

## ACCESSORIES

The arcoPlus® system includes a complete range of accessories to facilitate installation. For correct installation the ends of the air cells in the panels must be heat-sealed to prevent soiling on the inside.

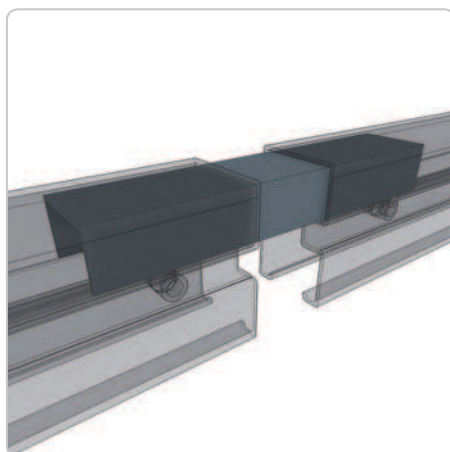

**CONNECTOR JOINT**  
AL connector profiles with eclipse

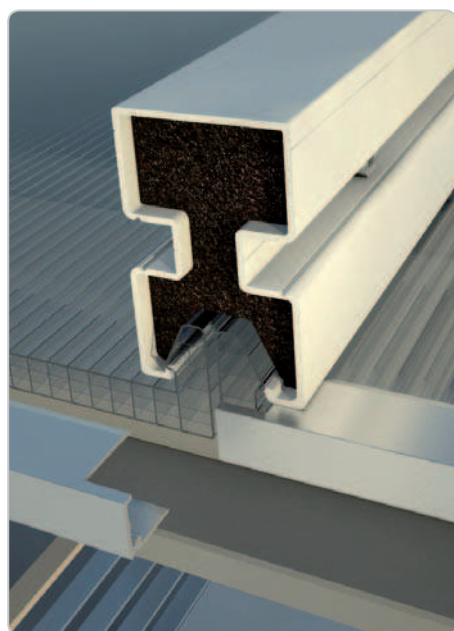

**DETAIL OF CONNECTOR**  
Use of aluminium joint screwed down and end closed with PE-LD pad

## METAL PROFILES

code 4310  
Connector AL  
profile with screw

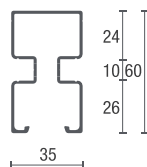

code 4245  
U-shaped closing  
support in AL

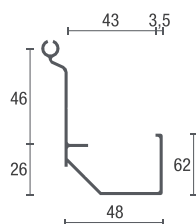

code 4252  
Closing  
support in AL



## ACCESSORIES



**4303**  
Covergasket  
stopper



**2146**  
Covergasket  
in polycarbonate



**2282**  
Double connector  
in polycarbonate

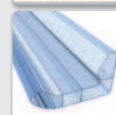

**2147**  
Start profile 684-6104  
in polycarbonate



**2245**  
Start profile 6124  
in polycarbonate



**2148** th.8mm  
**2265** th.10mm  
**2250** th.12mm  
End profile in PC



**4310**  
Connector AL  
profile with screw



**4245**  
U-shaped closing  
support in AL



**4252**  
Closing  
support in AL



**4319/200**  
AL eclipse  
for connector



**4326** th.8mm  
**4350** th.10mm  
**4355** th.12mm  
AL plate



**4264**  
Stainless steel plate  
for vertical connection



**4138**  
Stainless steel plate  
for flat connection  
(th.8mm)



**4675/600** th.8mm  
**4676/600** th.10mm  
**4677/600** th.12mm  
Block cover AL profile



**4213** dim. 40x35x580  
**4221** dim. 70x40x580  
Pad PE-LD



**4318**  
Pad PE-LD  
for connector

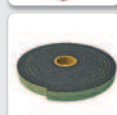

**4329**  
Sealing tape PE-LD  
4x15mm



**4316** M6 nut  
**4315** M6 x 20 screw  
Accessories for connector